

AVENUE IMPERIA

2/4

--- PROPOSED 9.00 M.W. ROAD ---

--- EXISTING 6.00 M.W. ROAD ---

45'-0"

ROAD WIDENING LINE

15'-0"

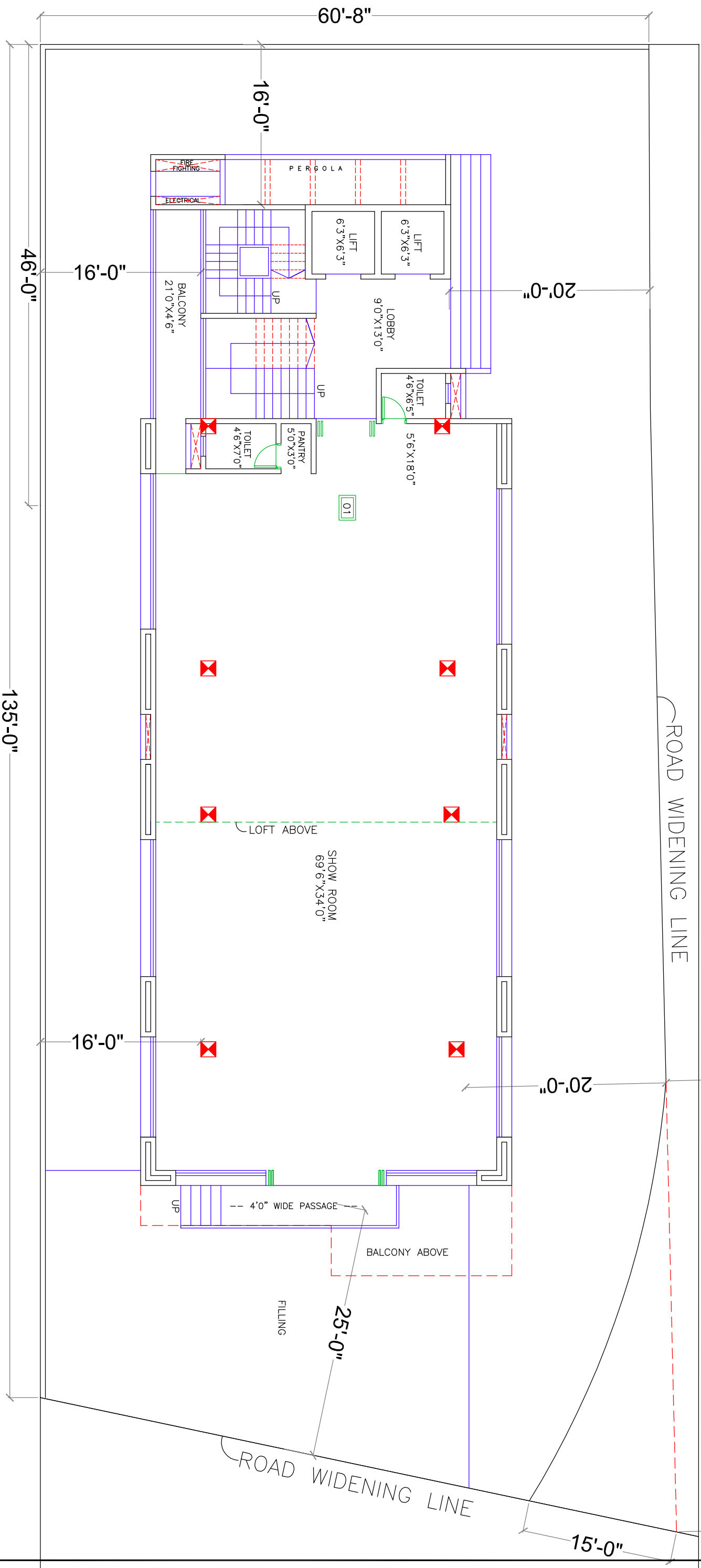

UPPER GROUND FLOOR PLAN

PROJECT :

PROPOSED BUILDING AT

S.NO.110/11/2, BANER,PUNE.

SHRI. AMIT SHETH SAHEB

SALEABLE AREA		SALEABLE AREA			
NO.	CARPET	LOFT	PASSAGE	SALEABLE AREA	
001	2662.00	1331.00	70.00	6095.00	

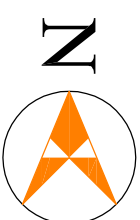

VILAS TARWADI

ARCHITECTS & INTERIOR DESIGNERS
 "SIDDHI GOLD" 1ST FLOOR S.NO.39'D
 SHANKAR SHETH ROAD, NEAR MEERA SOCIETY,
 GULTEKADI,PUNE 411037 PH. 26456334
 EMAIL - vilasatarwadi@gmail.com CA/92/14877

DATE	SCALE	DRAWN BY	JOB NO.
05.05.2016	---	Vinayak	

COMP 19/D: DWG/AMT SHETH/S.NO.110 BANER/SALE.